

W Pleasant Grove Drive

Rogers, Ar 72758

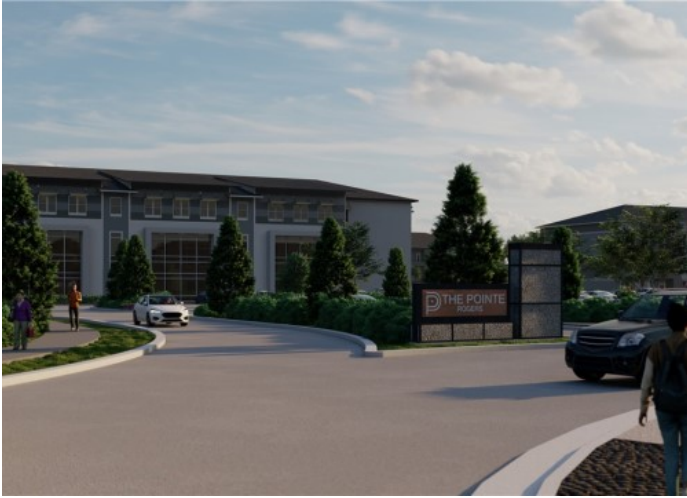

List Price: \$35
MLS#: 1230602
Beds: 0
Garage: 0
Square Feet: 14,000
Price / Square Foot: \$0.00
Type: CommercialLease
County: Benton
School:

Description

New Class A mixed use development located in close proximity to numerous amenities including the Walmart AMP, Top Golf, and many food and beverage options. This is for Phase I of the project.

Property Details

Lot Size	67.16 Acres
Listed By	Moses Tucker Partners-Bentonville Branch