

# 221 W Elm Street

Rogers, Ar 72756

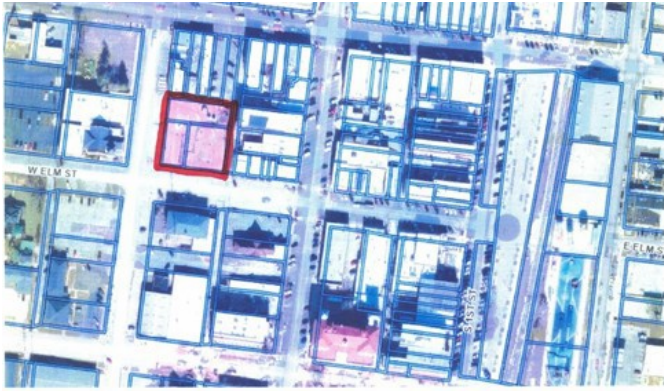

**List Price:** \$849,900  
**MLS#:** 1353080  
**Beds:** 0  
**Garage:** 0  
**Subdivision:** Rogers Orig Rogers  
**Type:** Land  
**County:** Benton  
**School:** Rogers

## Description

Corner lot in Downtown Rogers. One of the largest contiguous pieces left for Development. .48 acres Ready to develop into Commercial on lower floor and residential on upper floor

## Property Details

Lot Size	0.48 Acres
Fencing	None
Listed By	Synergy Realty Group, LLC